

## Instructor

Dr. Derek Borman



## Southern & Dobson Info

Office: BP43, B  
Phone: 461-7181  
Hours: TR, 9:30 - 10:30am

## Red Mountain Info

Office: None  
Phone: 461-7181  
Hours: MWF, 10 - 11am

## Syllabus Overview

Support	1
Attendance	1
Keys	2
Homework And Papers	2
Extra Credit	2
Extra, Extra Credit	3
Exams	3
Grades & Honors	4

## Disputes & Course Changes

Disputes over course protocol or policies will be handled face-to-face, during my office hours or other arranged hours.

This syllabus is subject to change at the instructor's discretion. You will be notified should such changes occur.



# Psychology 101

INTRODUCTION TO PSYCHOLOGY SPRING 2012

"Seems that very The last ones to know that they are wet are the fish."



## COURSE SUPPORT

We will be meeting at the designated time on **Tuesdays and Thursdays**. Even if I am absent, you will still be responsible for the assigned material.

**Course Website:** Our PSY 101 website is located at the URL listed at the bottom of this page. Exam reviews, practice quizzes, the syllabus,

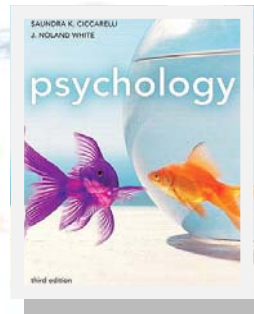

## Required Text:

*PSYCHOLOGY (3rd Ed.)*  
by Ciccarelli & White

PowerPoint slides and other vital information are located at this website.

**Other Web Resources:** Your text publisher maintains a companion website for the first edition of your textbook at: [http://wps.prenhall.com/hss\\_ciccarelli\\_psychology\\_1](http://wps.prenhall.com/hss_ciccarelli_psychology_1).

## PIRC LABORATORY

The MCC Department of Psychological Science maintains a facility known as the **PIRC**



[dborman@mesacc.edu](mailto:dborman@mesacc.edu)

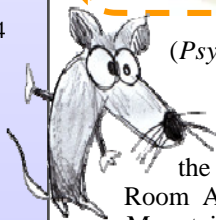

(Psychology Instructional Resource Center). **On the main campus**, the PIRC is located in Room AD2. At MCC Red Mountain, the PIRC is located on the 2<sup>nd</sup> floor of the library in the Desert Willow building.

## ATTENDANCE & WITHDRAWAL

Class attendance is mandatory. You begin the semester with **50 attendance points**. You will **LOSE 5 POINTS** for every day on which you did not sign the role. **YOU MUST BE IN CLASS ON TIME** and stay the entire class period to sign the role.

If you are absent for more than 5 days, your final **course grade will automatically be dropped one letter grade**. You are allowed to **make up two missed days**. More about this policy on the next page.

## Withdrawal and Refunds:

MCC students will be charged full tuition and fees (after the 100% refund period) when dropped from a course for any reason.



Last day to drop without instructor's signature: **Feb 20, 2012**.

**Withdrawing from the class is your responsibility!** I will not withdraw you unless you ask. Even if you stop showing up for class, I will not automatically withdraw you. Failure for you to initiate a withdrawal may result in a grade of "F" for the class.





## KEYS TO SUCCESS

**S**how up for class... every day.

**R**ead from your psychology textbook...every day.

**C**ritically read each chapter of the textbook...more than one time.

**D**efine psychology concepts...in your own words.

**T**alk to others about psychology...whenever and wherever you can.

**B**egin your preparation for the next exam...as soon as you finish the last one.

**U**se the exam review sheets to prepare for exams...at least two weeks before exams.

**T**ake tests and turn in assigned work...on time.

**B**e respectful of viewpoints presented by your peers...and your instructor.



Part of the challenge of psychology is to get beyond our assumptions and prejudices so that we can identify questions that are important and that don't have obvious answers. Here are some examples of questions we'll consider in the course:

- *Why do some people learn information differently than others?*
- *What is "intelligence" and how can it be tested?*
- *How are severe mental disorders diagnosed?*
- *Why are phone numbers seven digits long?*
- *Why are Republicans*

*more likely to be what we call "internalizers" and Democrats? "externalizers?"*

- *How does mass media impact our thoughts, feelings and behaviors?*

## COURSE OBJECTIVES

- To **become aware** of the major psychological approaches to the study of behavior.
- To **become aware** of the major problems investigated by psychologists.
- To **learn** of the history of psychology and the major contributors to the field.
- To **learn** the methodol-

ogy of psychology and its limitations.

- To **become an informed consumer** of psychological information.
- To **gain understanding** of yourself and others.
- To **prepare** you for further study in the field of psychology.
- To **improve** your study skills.



"Life is just one Rorschach test after another!"



## HOMEWORK: PSYK.TREK WORKSHEETS &amp; MULTIMEDIA ACTIVITIES

Multimedia Psyk.Trek activities are installed on **PIRC Lab** computers. Worksheets are completed in the PIRC lab. Psyk.Trek worksheets are located in the PIRC lab and on the course website. A total of 12 Psyk.Trek worksheets must be filled out completely and correctly to receive full credit.

**DUE:** See calendar  
**POINTS:** 10 pts each  
**TOTAL:** 120 pts.



## EXTRA CREDIT

1. **Evening Lecture:** Attendance and paper.  
**DUE:** Varies  
**POINTS:** 15/each
2. **Lecture-Related Projects:** Opportunities related to topics being discussed in class.  
**DUE:** Varies  
**POINTS:** 5/each
3. **YouTube Videos:** Create/upload a YouTube video that creatively demonstrates/defines a psychology concept from class. Must be at least two minutes and suitable for presentation in class.  
**DUE:** April 26th, 2012  
**POINTS:** 10/each
4. **EC Application Projects:** These projects are designed to help you connect psychological concepts with the world around you.  
**DUE:** See Calendar and course website  
**POINTS:** 15/each

## ABSENCE MAKEUP

**You may make up 2 absences.** Absences can be made up by attending an official MCC event (athletics, theater, etc.) and providing me with a ticket/receipt/etc. proving that you attended. There are some amazing events on our campus, so check MCC out!!





**In psychology, it's not enough to simply watch...**

way to enrich your psychology learning through videos, simulations and other hands-on activities. See me for details.

**EXTRA, EXTRA CREDIT!**

“EXTRA, Extra Credit?” Could it really be? Sounds crazy, doesn't it? And yet, here we are. There is one way to get above the 30-point limit on extra credit.

How? Sign up & pay for **1 credit of PSY 102** and complete the **Activities Manual** for the PSY 102 course. This is a great

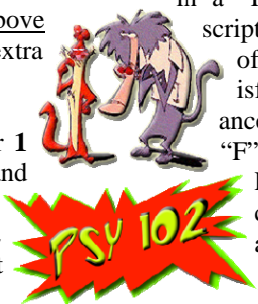

Satisfactory completion of the PSY 102 manual will increase your PSY 101 grade and result in a “P” (on your transcripts) for one credit of PSY 102. Dissatisfactory performance will result in an “F” for one credit of PSY 102. Partially completed manuals may receive

partial credit, at the instructor's discretion.

**DUE:** May 4, 2012

**POINTS:** 50

**IMPORTANT!** You may do “Extra Credit” (for a maximum 30 points) **OR** “Extra, Extra Credit” (for a maximum of 50 points) **BUT** not both. In other words, you cannot earn more than 50 extra credit points in the class—no matter how much outside work you do.



**...you have to jump in and meet the material, head on.**

**EXAMS**

There will be **4 exams** administered during the quarter.

**About The Exams:**

- 100 points/exam
- 50 multiple-choice items (application/conceptual)
- You may use a 3x5, hand-written note card during test.
- Application-type questions
- **KNOW YOUR REVIEW SHEETS!!**



**Other Important Points:**

You are allowed one make-up exam for a missed test. Make-ups will be administered on the day of the final Which means that you will need to prepare for two exams instead of one.



**IMPORTANT!** Bring a #2 pencil and a green Scantron form # **882-E** to class on test day.

Scantron forms can be purchased from the MCC bookstore.

**Disabilities:** If you have a disability that will require some special testing accommodations, you must document your disability through the **Disability Resource Center** at MCC. You can find them on the web at: [www.mc.maricopa.edu/students/disability](http://www.mc.maricopa.edu/students/disability).

The phone number for the Disability Resource Center is: 461-7447.

*“Psychology is all around us and it happens fast. If you don't stop, look and think...you might miss it.”*



**EARS -- EARLY ALERT REFERRAL SYSTEM**

MCC has adopted an Early Alert Referral System as part of a student success initiative. Faculty and staff participate by alerting and referring students to campus services for added support. Students may receive a follow-up call from various campus services as a result of being referred to EARS. Students are encouraged to participate, but these services are optional. The EARS website is located at: <http://www.mesacc.edu/students/ears>.



## GRADING IN THIS COURSE

Point breakdown: Introduction Photo (10 pts.) Exams (400 pts.), Psyk.Trek homework (120 pts.), and Attendance (50 pts.) Total points possible for the class: 580. The grading scale is listed below:

90 – 100%	=	A
80 – 89%	=	B
70 – 79%	=	C
60 – 69%	=	D
0 – 59%	=	F

Grades are generally reflective of the amount of effort you put into the course. You will find that you can improve your grades by following the *Keys To Success* listed previously.



**Academic dishonesty will result in an F in this course.** If you are unsure as to what constitutes academic dishonesty, please refer to the following website:

[http://www.mc.maricopa.edu/services/student\\_services/dean/legal/index.html](http://www.mc.maricopa.edu/services/student_services/dean/legal/index.html)

## HONORS STUDENTS

**UNLESS THE HONORS-ONLY SECTION IS FULL, YOU CANNOT BE ENROLLED IN THIS CLASS AS AN HONORS STUDENT.**



Students registered for an **Honors Section** of this course, must also:

1. Register for and successfully complete 1 credit of **PSY 102** and successfully complete the PSY 102 manual before the end of the semester. Satisfactory completion of the PSY 102 manual will result in a "P" for one credit of PSY 102. Dissatisfactory performance will result in an "F" for one credit of PSY 102.

**DUE: May 4, 2012**

**POINTS: 50**

2. Complete the **Research/Presentation Project** for the course. I will provide Honors Students with the details.

**DUE:** Multiple due dates  
**POINTS: 50**



**Honors students will complete these requirements instead of the Psyk.Trek activities required for other students.**

### Starting PSY102

After registering and paying for one credit of PSY 102, you will:

1. Go to the PIRC Lab (Rm. AD2).
2. Introduce yourself to a PIRC assistant
3. Complete the PSY 102 computer orientation.
4. Get a PSY 102 manual and complete it by the due date.

**NOTE:** Whereas others in class may complete one credit of PSY 102 for 50 points of extra credit, Honors students will work from a slightly different PSY 102 manual and will receive no extra credit for this activity. This activity is simply the requirement for Honors students. Should Honors students desire another way to earn "Extra, Extra Credit" (50 pts), a way will be provided.

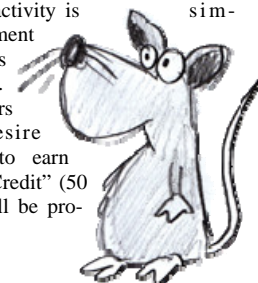

Spring 2012

## Psychology Instructional Resource Center \* PΨRC \*

The PΨRC is a computerized learning center that provides resources and technology to help students learn psychology. Students have access to the internet, instructional videos, and interactive computer based psychology programs. Textbooks and other printed materials are available for use in the PΨRC. The Tutor Center is free and located in the PΨRC. The PΨRC can be used for group or private study. Your lab fees support the PΨRC – use it!

Stay informed  Find us on Facebook

<http://www.facebook.com/mcc.pirc>

### PΨRC HOURS

Monday	7AM-7PM
Tuesday	7AM-7PM
Wednesday	7AM-7PM
Thursday	7AM-7PM
Friday	7AM-4PM
Saturday	7AM-2PM

### Tutor Center Hours

Monday	9AM-2PM
Tuesday	9AM-2PM
Wednesday	9AM-2PM
Thursday	9AM-2PM
Friday	9AM-1PM

### PΨRC is located in AD Building AD2

#### Student Driven Study Groups

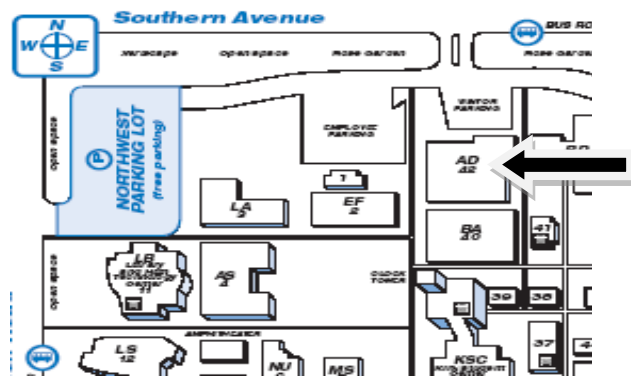

Monday – Thursday 3:30 pm  
Friday 10:00 am

#### Psych Movies in the PIRC

Friday – noon & 2:00pm  
**FREE POPCORN!**

### PSY102

PSY102 is a 1 credit laboratory course which corresponds to your Introduction to Psychology (PSY101) class. Manuals are available in the PIRC. This manual represents the core curriculum for the lab credit and consists of 14 general topics covered in PSY101. The activities are designed to enhance your learning, improve your critical thinking skills and academic performance, and further your knowledge of Psychology.

**Note:** if you are taking PSY101 for honors credit, PSY102 is a departmental requirement.